

The *Greg Mortimer*

Staterooms & Suites Layout

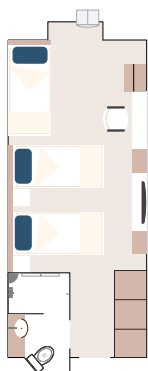

Aurora Stateroom Triple

Stateroom 21.4m²–22.8m²,
porthole and bathroom.

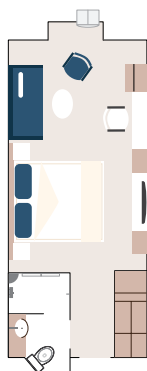

Aurora Stateroom Twin

Stateroom 15.8m²–22.8m²,
porthole and bathroom.

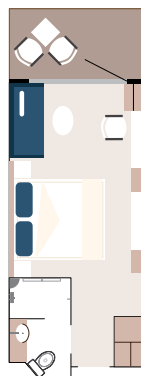

Balcony Stateroom

Stateroom and private
balcony combined size
20.9m²–31.3m², balcony and
bathroom. For stateroom
sizes in categories A, B and C,
please contact us.

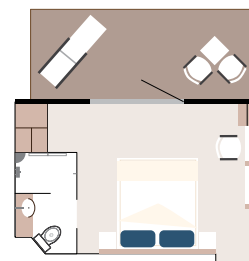

Balcony Stateroom Superior

Stateroom and private
balcony combined size
30.5m²– 40.2m², balcony and
bathroom.

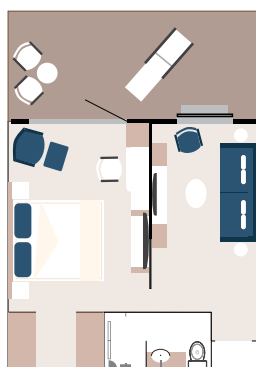

Junior Suite

Stateroom and private
balcony combined size
38.9m², balcony, bathroom
and lounge.

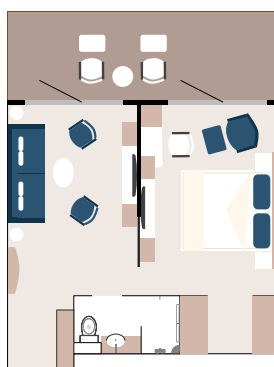

Captain's Suite

Stateroom and private
balcony combined size
44.5m², balcony, bathroom
and lounge.



*Layouts are a guide only, the cabin configuration may vary dependent on the location of the cabin on the ship.

For more information on the *Greg Mortimer*
visit aexpeditions.co.uk/the-greg-mortimer